



**CATALOGO GENERALE SINTETICO**  
**SMALL GENERAL CATALOGUE**



**Sede legale: VIA TORINO, 77/1 – 10040 DRUENTO (TO)**

**☎: +39 011/19775115 --- ☎: +39 011/9942666**

**E-Mail : [info@sidarma.it](mailto:info@sidarma.it) --- [http : www.sidarma.it](http://www.sidarma.it)**

**RUOTE E SUPPORTI**  
**WHEELS AND CASTORS**

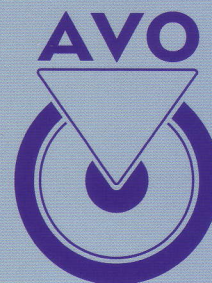

*MOVE YOUR WORLD*

**A L D O V A L S E C C H I**



## Ghisa - Cast Iron

Ruote in ghisa meccanica di alta qualità a foro passante o con cuscinetti a sfere, disponibili in una gamma di diametri che va da mm 80 a mm 270 e che abbinate alle diverse tipologie di supporti medi, pesanti ed extraspesanti consentono portate comprese tra Kg 100 e Kg 2100.

*High quality mechanical cast iron wheels, plain bore or with ball bearings, available in a range of diameters between mm 80 and mm 270 and combined with the various types of medium duty, heavy duty and extra heavy duty castors allow load capacities between Kg 100 and Kg 2.100.*



## Alta Temperatura High temperature

Ruote in resina fenolica, ruote con rivestimento gomma e nucleo in poliammide carica-vetro o ruote in gomma silconica con flange in ferro per applicazioni ad alta temperatura fino a 280 C°, disponibili in una gamma di diametri che va da mm 80 a mm 250.

*Phenolic resin wheels, wheels with rubber tyre and fiberglass polyamide centre or wheels with high temperature silicone rubber tyre with steel flanges, suitable for high temperature applications till 280 C°, available in a range of diameters between mm 80 and mm 250.*



## Pneumatica - Pneumatic

Ruote pneumatiche con nucleo in materiale termoplastico o in acciaio, disponibili in una gamma di diametri che va da mm 200 a mm 400 e che abbinate alle diverse tipologie di supporti medi consentono portate comprese tra Kg 75 e Kg 200.

*Pneumatic wheels with thermoplastic material centre or with steel centre, available in a range of diameters between mm 200 and mm 400 and combined with the various types of medium duty castors allow load capacities between Kg 75 and Kg 200.*



## Speciali - Special products

Articoli per applicazioni particolari quali ponteggi mobili, teatri, carrelli postali, betoniere etc.

*Castors for special applications as scaffolding, theatres, post trolleys, concrete mixers etc.*



# Poliuretano - Polyurethane

Ruote in poliuretano AVOLAN ed AVOPRENE con nucleo in ghisa meccanica di qualità, alluminio o in acciaio elettrosaldato, disponibili anche con poliuretani speciali - AVOANTISTATICO, AVOWATER, AVOBIO - e poliuretano soft. Ruote con poliuretano ad iniezione e nucleo in poliammide 6. Queste ruote hanno una gamma di diametri che va da mm 80 a mm 500 e che abbinata alle diverse tipologie di supporti medi, pesanti ed extra pesanti consentono portate comprese tra Kg 120 e Kg 7500.

*Wheels with AVOLAN and AVOPRENE polyurethane tread with high quality mechanical cast iron centre, aluminium centre or with electrowelded steel centre, available also with special polyurethanes - AVOANTISTATICO, AVOWATER, AVOBIO - and with soft polyurethane. Wheels with injection polyurethane tread and polyamide 6 centre. These wheels are available in a range of diameters between mm 80 and mm 500 and combined with the various types of medium duty, heavy duty and extra heavy duty castors allow load capacities between Kg 120 and Kg 7.500.*

<b>Art. 14</b> 	<b>Art. 15</b> 	<b>Art. 14V/14W/14AS</b> 	<b>Art. 22</b> 	<b>Art. 22A</b> 	<b>Art. 24ANT</b> 
<b>Art. 24</b> 	<b>Art. 27</b> 	<b>Art. 27A</b> 	<b>Art. 29</b> 	<b>Art. 30Y/30</b> 	<b>Art. 30YA</b> 
<b>Art. 30YBIS</b> 	<b>Art. 33Y/33</b> 	<b>Art. 33YA</b> 	<b>Art. 18A</b> 	<b>Art. 18W/18AS/19</b> 	<b>Art. 37</b> 
<b>Art. 37A</b> 	<b>Art. 37ANT</b> 	<b>Art. 38</b> 	<b>Art. 38A</b> 	<b>Art. 38BIS</b> 	<b>Art. 600/601</b> 
<b>Art. 17</b> 	<b>Art. 31</b> 	<b>Art. 31A</b> 	<b>Art. 31ANT</b> 	<b>Art. 32</b> 	<b>Art. 32A</b> 
<b>Art. 32BIS</b> 	<b>Art. 17L</b> 	<b>Art. 31L</b> 	<b>Art. 31LA</b> 	<b>Art. 31LBIS</b> 	<b>Art. 21</b> 

## Arredamento - Furniture castors

Ruote e supporti per arredamento, mobili d'ufficio, espositori, elettrodomestici, attrezzature ospedaliere, disponibili con battistrada in gomma, in materiale termoplastico, poliuretano e legno, con finitura zincata, cromata, ottonata e verniciatura nera. Questi articoli sono disponibili in una gamma di diametri che va da mm 30 a mm 125 con portate comprese tra Kg 15 e Kg 100.

*Wheels and castors for furniture applications, office furniture, exhibitors, electrical household, hospital equipments, available with rubber tyre, thermoplastic material, polyurethane or wood, with zinc plated finishing, chrome plated finishing, brass plated finishing or black painted. These products are available in a range of diameters between mm 30 and mm 125 and with load capacities between Kg 150 and Kg 100.*

**Art. 220C**



**Art. 220CBIS**



**Art. 220CB**



**Art. 220CBISB**



**Art. 220CF**



**Art. 220CBISF**



**Art. 150**



**Art. 150B**



**Art. 155**



**Art. 155BIS**



**Art. 155H**



**Art. 155BISB**



**Art. 164**



**Art. 164BIS**



**Art. 164B**



**Art. 164BISB**



**Art. 165**



**Art. 165B**



**Art. 160**



**Art. 160BIS**



**Art. 172**



**Art. 172BIS**



**Art. 172B**



**Art. 172BISB**



**Art. 173**



**Art. 173BIS**



**Art. 221**



**Art. 221BIS**



**Art. 500**



**Art. 220**



**Art. 300/300AT**



**Art. 301/301AT**



**Art. 302/302AT**

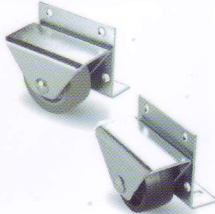

**Art. 210**



**Art. 275**



**Art. 275BIS**

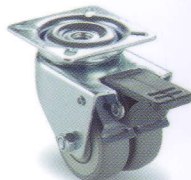

Ruote e supporti per l'arredamento

## Rulli - Pallet rollers

Rulli per transpallet in poliuretano AVOLAN ed AVOPRENE con nucleo in acciaio, disponibili anche con poliuretani speciali - AVOANTISTATIC, AVOWATER - e poliuretano soft. Rulli in poliammide 6 di alta qualità. Rulli con nucleo in poliammide 6 e rivestimento in poliuretano ad iniezione. Questi rulli hanno una gamma di misure che va da mm 70x70 a mm 85x100 e che abbinata alle diverse tipologie di supporti extra pesanti consentono portate comprese tra Kg 200 e Kg 1000.

*Pallet rollers with AVOLAN and AVOPRENE polyurethane tread with steel centre, available also with special polyurethanes - AVOANTISTATIC, AVOWATER - and with soft polyurethane. High quality polyamide 6 pallet rollers. Pallet rollers with polyamide 6 centre and injection polyurethane tread. These rollers are available in a range of diameters between mm 70x70 and mm 85x100 and combined with the various types of extra heavy duty castors allow load capacities between Kg 205 and Kg 1.000.*

Art. 10/11

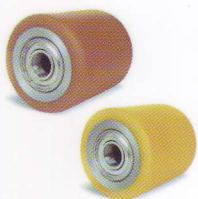

Art. 51



Art. 51A



Art. 12



Art. 52



Art. 52A



Art. 13



Art. 53



Art. 53A



## Supporto - Castor

### SUPPORTI TIPO:

- Medio (portata 50/500 kg).
- Pesante (portata 150/750 kg).
- Extra-pesante (portata 200/4000 kg).

### CASTORS:

- Medium duty (load capacity 50/500 kg).
- Heavy duty (load capacity 150/750 kg).
- Extra heavy duty (load capacity 200/4000 kg).

### Medium



### Heavy



### Extra-Heavy



### Twin



## Inox

Supporti medi in acciaio inossidabile abbinati a ruote in poliammide 6, in poliammide 6 con rivestimento in poliuretano ad iniezione, in gomma elastica, in resina fenolica per alta temperatura o in gomma grigia antimacchia e nucleo in materiale termoplastico, disponibili in una gamma di diametri che va da mm 80 a mm 200 e con portate comprese tra Kg 150 e Kg 600.

*Medium duty stainless steel castors with polyamide 6 wheels, with injection polyurethane tread and polyamide 6 centre, elastic rubber wheels, high temperature phenolic wheels or with grey no-marking rubber tyre and thermoplastic centre, available in a range of diameters between mm 80 and mm 200 and with load capacities between Kg 150 and Kg 600.*

Art. 119



Art. 119A



Art. 119ANT



Art. 119ANTF



Art. 31XF



Art. 31XANTB



Art. 117X



Art. 117XA



Art. 117XB



Art. 90X



Art. 90XB



Art. 90XANT



Art. 90XANTB



Art. 66X



Art. 66XA



Art. 66XB



Art. 66XF



Art. 66XANTB

